

# Shops at Kanawha

## Charleston, WV

The Shops at Kanawha is a redevelopment at the former Kanawha Mall site in Charleston, West Virginia. The project began with the opening of a new 80,000 sq. ft. Elder Beerman in March, 2006. Conversion of the enclosed mall into an open-air center was begun earlier this year and is expected to be completed before Christmas, 2008. The Shops at Kanawha is conveniently located at the intersection of MacCorkle Ave. and I-64, I-77, the busiest interchange in the State of West Virginia. Daily traffic counts for these major thoroughfares, adjacent to the mall, are as follows:

- I-64, I-77 118,000 cars per day
- MacCorkle Ave. 26,400 cars per day

### TRADE AREA

2008 Population	236,124
Avg. HH Income	\$54,561
No. of Households	108,731

### ANCHOR TENANTS

Elder Beerman	80,000 SF
Gabriel Bros.	66,500 SF
Kroger	58,000 SF

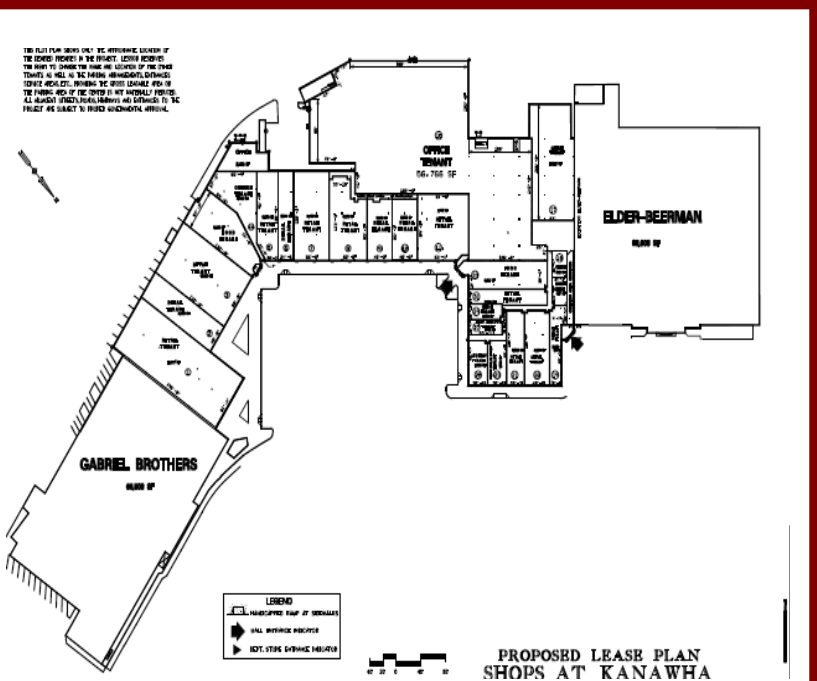

**simpson properties, inc.**

your partner in property management